



OUR  
MOTORHOMES



**AVIDA**

*Discover your dreams*





Avida, a great Australian story, has been manufacturing RVs since 1965 in Western Sydney NSW. Avida remains the number one manufacturer of Motorhomes in Australia with over 50 years of experience building RV products like motorhomes, campervans and caravans. At a time when much of Australia's manufacturing is fast disappearing overseas to the detriment of local jobs, Avida remains in the original hands of the founder as a true Australian family company employing and supporting hundreds of Australians and their families at the 4 hectare (10 acre) site. You can be very confident you've made the right decision when you purchase an Avida.

Avida – Australian owned, Australian built.

WELCOME TO THE GREAT LIFESTYLE  
OF MOTORHOMING!



MOTORHOMES AVAILABLE:

- A, B & C TYPES
- LARGE SLIDE OUTS
- WHEELCHAIR FRIENDLY
- LUXURY
- MULTI TERRAIN
- 2-6 BERTH
- LOW PROFILE



## OUR HISTORY



**1965**  
Beginning of  
Freeway Camper Company



**1965**  
First built slide on  
motorhome



**1975**  
First built caravan



**1975**  
First built  
5th wheeler



**1978**  
Started to manufacture  
Winnebago product



**1980**  
First low profile  
motorhome with one  
piece fibreglass body



**1990**  
25th year edition  
motorhome



**1995**  
First slide out



**1996**  
First export to Japan



**2000**  
First Toy hauler for  
Industry Millennium



**2000**  
Sydney Olympic  
Games  
support vehicles



**2003**  
First electric roll down  
bed model



**2013**  
Rebrand to Avida



**2013**  
Reintroduction  
of caravans



**TODAY**  
Over 50 years strong

**Y**ou're about to follow your dreams of a lifetime discovering what this great country has to offer.

Motorhoming is a great lifestyle that appeals to numerous people worldwide. Australia is such a vast country and with so much to offer in regards to locations to visit; from the beautiful sapphire coastline to the arid red centre, it is truly a diverse landscape.

Not all motorhomes are created equal and not all are designed with Australia's harsh environment conditions in mind or the specific demands of self-contained living. The more research you do, the better equipped you will be to make the right purchase decision for you.

At Avida we understand that purchasing a motorhome is a significant investment and with our dedicated in-house research and development team using the latest technology and engineering available we will continue to build industry leading motorhomes to suit your needs.

To find out what makes Avida motorhomes different from other motorhomes, why not ask one of our factory trained and accredited Avida dealers.

Discover your dreams with an Avida motorhome and escape to wherever the open road takes you.

Happy Motorhoming!

3D TOURS ONLINE

Avida Torquay B7954 SL



Explore 3D Space

3D SHOWCASE



## UNIQUE CONSTRUCTION

Avida has been investing millions of dollars in the most advanced technology since 1965 and today is at the cutting edge of design in Australia with the most technologically advanced manufacturing plant at the 10 acre site in Sydney. From the latest three dimensional CAD software, the computer numeric controlled (CNC) cutting equipment, through to the unique PUR hot melt adhesive lamination and cutting system, the technology Avida use is second to none.

All Avida motorhomes are built using this latest technology, like the unique and environmentally friendly lightweight insulated sandwich panel construction used to produce the strongest floor, walls and roof on the market. Avida also place adhesive coated metal plates in the insulated panels using laser guidance to ensure 100% accuracy during manufacturing.

The engineered Avida body is designed for the tough outdoor conditions with all stress loads shared from the unique construction process. This construction process demonstrates the extra effort made by Avida to build the strongest motorhomes on the market.

### FLOOR / WALL

- EXTERNAL WALL FIBREGLASS
- EXTERNAL WALL SUPALITE
- WALL INSULATION
- INTERNAL WALL SUPALITE
- FLOOR DOUBLE PLY
- FLOOR INSULATION
- FLOOR DOUBLE PLY

UNDERFLOOR ALUMINIUM PROTECTION

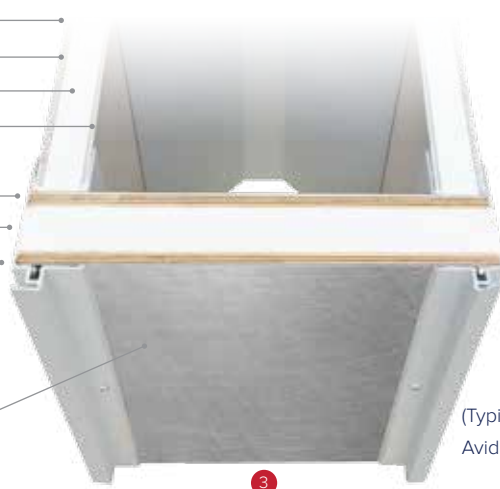

(Typical floor – 12mm Ply, Avida floor 45mm – 60mm)

### DID YOU KNOW?

Avida is Australia's No.1 Motorhome manufacturer



### AVIDA'S UNIQUE SANDWICH PANEL CONSTRUCTION ADVANTAGES:

- 1 **WALL Construction** – The lightweight sandwich panel Avida walls are fixed to the top of the floor as opposed to being screwed to the floor side, providing additional strength that are also dent resistant with an easy to clean external fibreglass surface.
- 2 **One Piece ROOF Construction** – The lightweight single piece sandwich panel Avida roof is glued, screwed and fully waterproofed to ensure strength, longevity and sealing.
- 3 **One Piece FLOOR Construction** – The lightweight sandwich panel floor design adds strength and prevents movement under foot with the underside of the floors completely covered in metal sheeting to ensure a long lasting easy to clean surface.

### ROOF / WALL

EXTERNAL ROOF FIBREGLASS

EXTERNAL ROOF SUPALITE

ROOF INSULATION

INTERNAL ROOF FIBREGLASS

WALL TO ROOF CABLE AND COMPONENT COVER

FLOOR VINYL

ALUMINIUM WALL TO ROOF EXTRUSION



# **AVIDA BIRDSVILLE**

The Avida Birdsville range is already one of the more popular motorhomes on Australian roads thanks to its very economical price and standard car licensing. Available in a variety of layouts which are all fully self-contained with single or double beds, well equipped kitchens and ample storage space, now with the option of a slide out room. It's built on the powerful Fiat Ducato chassis, providing a harmony of performance and economy without sacrificing creature comforts.



**Sleeps:** 4 – 6     **Seatbelts:** 4 – 6  
**Licence:** Standard     **Type:** B & C Type

## Large Full Length Slide Out Models

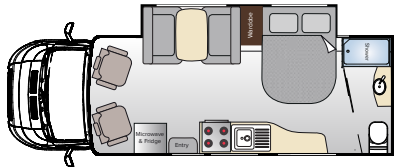

**B7424SL**  
 rear bathroom  
 with island bed  
 huge slide out

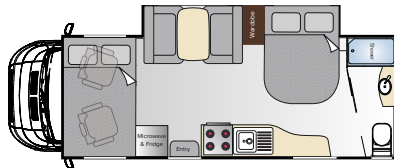

**C7424SL**  
 rear bathroom  
 with island bed  
 huge slide out



## Non Slide Out Models

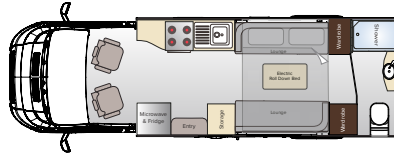

**B7434**  
 with electric  
 roll down bed

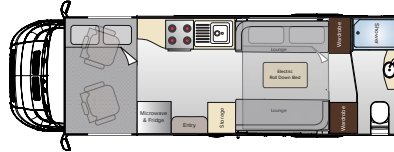

**C7436**  
 with electric  
 roll down bed



Optional 



## SPECIFICATIONS

Exterior height	B type 3085mm / C type 3125mm
Exterior width	2320mm
Exterior length	7390mm
Interior height	1973mm
Fresh water	124ltr
Grey water	124ltr
Black water	17ltr
Chassis type	Fiat Ducato
Engine	4 cylinder turbo diesel
Output power	130 kw @ 3500 rpm
Torque	400 Nm @ 1500 rpm
Transmission	Manual/MTA (Auto)
GVM	4400kg





## UPHOLSTERY



- Esperance style, Chestnut glaze colour collection shown
- There are plenty of interior colour collections to choose from.
- Go online to see the collections available.

## BENCH TOPS



- Charcoal bench top shown
- There are several bench top colours with different finishes to choose from.

## DECALS



- Spiced mushroom colour collection shown
- There are numerous exterior colour collections to choose from.

## SPLASHBACKS



- Woodgrain Maroon splashback shown
- There are many splashback colours to choose from.

## EXTERIOR FIBREGLASS



- Champagne fibreglass shown
- There are a variety of exterior fibreglass colours available to choose from.

BE THE FIRST TO FIND OUT  
ABOUT OUR NEW MODELS.

JOIN THE AVIDA NEWSLETTER AT  
[avidarv.com.au](http://avidarv.com.au)

VISIT THE AVIDA WEBSITE  
FOR THE FULL LIST OF CHOICES  
[WWW.AVIDARV.COM.AU](http://WWW.AVIDARV.COM.AU)



# AVIDA FEATURES



PERSONALISE

## QUALITY INCLUSIONS

	Leura	Birdsville	Ceduna (T)	Eyre	Esperance	Torquay	Longreach
Air-conditioner – Roof mounted	o	✓	✓	✓	✓	✓	✓
Avida's own 12 & 240 volt integrated distribution control panel & energy management system	✓	✓	✓	✓	✓	✓	✓
Avida's unique, strong, highly insulated and light weight sandwich panel construction with aluminium underfloor protection	✓	✓	✓	✓	✓	✓	✓
Bar/entertainment area with 49inch TV and sound bar	-	-	-	-	-	-	-
Compliance – Certified weight certificate ex-factory with every vehicle	✓	✓	✓	✓	✓	✓	✓
Compliance – RVMAP industry accredited manufacturer (look for the accreditation key)	✓	✓	✓	✓	✓	✓	✓
External entertainment unit with radio speakers, table, 12 volt & 240 volt power & provision for TV	-	-	-	-	✓	✓	✓
Fridge/freezer – 190 litre	-	✓	✓	✓	✓	✓	✓
Insulated walls & roof	✓	✓	✓	✓	✓	✓	✓
LED mood lighting throughout	-	-	-	✓	✓	✓	✓
Microwave – Stainless steel	✓	✓	✓	✓	✓	✓	✓
Motorhome battery in addition to the chassis battery – 100 amp 12 volt	x 1	x 1	x 2	x 2	x 2	x 2	x 3
Recessed 3 burner LPG & 1 electric stainless steel stove with glass lid for extra bench space	-	✓	-	✓	✓	✓	✓
Recessed LPG stainless steel stove with glass lid for extra bench space	2 burner	-	3 burner	-	-	-	-
Slide out pantry	-	✓	✓	✓	✓	✓	✓
Splashback – Choice of several styles & colours	✓	✓	✓	✓	✓	✓	✓
Solar panel system with regulator	o	o	o	o	o	o	✓
Television with DVD player	✓	✓	✓	✓	✓	✓	x 3
Truma iNet – Control your hot water system/ heater, and airconditioner through your phone	-	-	-	-	-	-	-
TV antenna – With signal booster	✓	✓	✓	✓	✓	✓	✓
USB charging station	✓	✓	✓	✓	✓	✓	✓
Vinyl floor throughout – Choice available	✓	✓	✓	✓	✓	✓	✓

## INTERIOR HIGHLIGHTS

Battery charger for motorhome battery	16amp	16amp	22amp	22amp	22amp	22amp	22amp
Battery charger for motorhome battery	16amp	16amp	22amp	22amp	22amp	22amp	60amp
Bench tops – Selection available to choose from	✓	✓	✓	✓	✓	✓	✓
Cabinet door hardware – D handle with positive catch	✓	✓	✓	✓	✓	✓	✓
Carpet mats – Removable	o	o	o	o	o	o	o
Cutlery drawer insert	✓	✓	✓	✓	✓	✓	✓
Day & night shades	-	-	-	-	o	o	✓
Décor – Colour co-ordinated throughout	✓	✓	✓	✓	✓	✓	✓
Diesel furnace heater	o	o	o	o	✓	✓	✓
Earth leakage protector – 240 volt	✓	✓	✓	✓	✓	✓	✓
Electric roll down bed *	✓	✓	✓	-	✓	-	-
Electric slide out bed with tilt	-	-	-	-	-	-	-
Extended bench top	-	✓	-	-	✓	✓	✓
Fridge/freezer – 106 litre	✓	-	-	-	-	-	-
Fridge/freezer – 50 litre in bar/entertainment area	-	-	-	-	-	-	-
Fridge/freezer compressor	o	o	o	o	o	o	o
Full length wardrobe	✓	✓	✓	✓	✓	✓	✓
Hot water system 12 volt electric start/gas & 240 volt	✓	✓	✓	✓	✓	✓	✓
Invertor	-	-	-	-	150w	150w	3000w
Large skylight with flyscreen and blind over cabin	o*	o*	-	✓	-	✓	-

	Leura	Birdsville	Ceduna (T)	Eyre	Esperance	Torquay	Longreach
Lift up bed on gas struts	-	✓	✓	✓	✓	✓	✓
Magazine holder	✓	✓	✓	✓	✓	✓	✓
Oven – Gas	-	o	-	✓	✓	✓	✓
Power – 12 & 240 volt	✓	✓	✓	✓	✓	✓	✓
Reading lights	✓	✓	✓	✓	✓	✓	✓
Roof vent in bathroom	✓	✓	✓	✓	✓	✓	✓
Seating with choice of fabric collections	✓	✓	✓	✓	✓	✓	✓
Separate tap at sink with water filter	o	o	o	o	✓	✓	✓
Shelving	✓	✓	✓	✓	✓	✓	✓
Shower	✓	✓	✓	✓	✓	✓	✓
Single lever mixer water taps	✓	✓	✓	✓	✓	✓	✓
Slide out room/s – For extra living space*	-	✓*	-	✓*	✓*	✓	✓
Stereo speakers in the rear	-	✓	✓	✓	✓	✓	✓
Storage – Ample throughout	✓	✓	✓	✓	✓	✓	✓
Swivel bracket – Fitted to TV *	✓	✓	✓	✓	✓	✓	✓
Table in lounge area – Removable	✓	✓	✓	✓	✓	✓	✓
Tank & battery monitor system	✓	✓	✓	✓	✓	✓	✓
Toilet roll holder	✓	✓	✓	✓	✓	✓	✓
Toilet with cassette	✓	✓	✓	✓	✓	✓	✓
Tooth brush holder	✓	✓	✓	✓	✓	✓	✓
Towel rail	✓	✓	✓	✓	✓	✓	✓
Tri fold table at dinette	-	o	-	-	o	o	o
Vacuum cleaner	o	o	o	o	o	o	o
Vanity basin	✓	✓	✓	✓	✓	✓	✓
Washing machine	-	o	o	-	o	o	✓
Waste pipes – Large to allow for better flow and minimise blocking – 40 mm in diameter	✓	✓	✓	✓	✓	✓	✓
Windows – Day & night shades	-	-	-	-	o	✓	✓
Windows – Double insulated dual pane with blind & flyscreen	-	✓	-	✓	-	-	-
Windows – Louvre windows with fly screens	✓	-	✓	-	✓	✓	✓
Windshield privacy curtain	✓	✓	✓	✓	✓	✓	✓
Wine bottle storage *	-	-	-	-	✓*	✓	✓

## EXTERIOR HIGHLIGHTS

Acrylic tail light surrounds	-	-	-	-	✓	-	-
Aerodynamic moulded front	✓	✓	✓	✓	✓	✓	✓
Awning – Electric	o	o	o	o	o	o	o
Awning – Light/s	✓	✓	✓	✓	✓	✓	✓
Awning – Roll out	-	o*	✓	-	✓	✓	✓
Awning – Wind out	✓	✓	-	✓	-	-	-
BBQ fitting	o	o	✓	o	✓	✓	✓
BBQ – on slide out tray	-	-	-	-	-	-	-
Chassis – Bull bar	-	-	o	-	o	-	o
Chassis – Nudge bar	o	o	o	o	o	o	-
Entry step – Electric	-	✓	✓	✓	✓	✓	✓
Entry step – Manual	✓	-	-	-	-	-	-
Exclusive decals – Choice of many colour collections	✓	✓	✓	✓	✓	✓	✓
External grab rail with light	✓	✓	✓	✓	✓	✓	✓
External slide out kitchen sink – with ancillaries & BBQ caddy	-	-	-	-	-	-	✓
External speakers – With additional radio inside	-	-	-	✓	-	-	-
External surface mounted table	o	o	o	o	-	-	-
Fridge – 12 volt external	-	-	-	-	-	-	✓
Full length roof guttering	✓	✓	✓	✓	✓	✓	✓



	Leura	Birdsville	Ceduna (T)	Eyre	Esperance	Torquay	Longreach
Generator – Programmable energy command with remote start	–	–	–	–	–	2.3kva ✓	3.6kva ✓
LED clearance lights	✓	✓	✓	✓	✓	✓	✓
LP gas bottle	2x4kg	2x4kg	2x4kg	2x4kg	2x4kg	2x4kg	2x9kg
Motorhome entry door with dead bolt & fly screen	✓	✓	✓	✓	✓	✓	✓
Moulded wheel arch flares	✓	✓	✓	✓	✓	✓	✓
Mud flaps on rear wheels	✓	✓	✓	✓	✓	✓	✓
Power point – external 240 volt	–	–	o	o	✓	✓	✓
Roof rack & ladder	o	o	o	o	o	o	✓
Satellite – TV receiver system automatic	–	–	–	–	–	o	o
Shower – External with hot and cold water	o	o	o	o	✓	✓	✓
Solar panel wiring provisions	✓	✓	✓	✓	✓	✓	✓
Stabilisers – Hydraulic stabilisers	–	–	–	–	–	o	o
Storage – On slide out for small BBQ, or portable generator	–	–	–	–	✓	✓	–
Storage bin – Lights	✓	✓	✓	✓	✓	✓	✓
Storage bins – Hinged from side for easy access	–	–	–	–	–	–	✓
Storage bins – Pass through	–	–	✓	✓	✓	–	✓
Stylish moulded rear wall	✓	✓	✓	✓	✓	✓	✓
Tow bar & wiring	o	o	o	o	o	o	✓
Water tank – Additional	–	–	o	o	o	–	o

#### SAFETY FEATURES

ABS – Antilock braking system	✓	✓	✓	✓	✓	✓	✓
ADR approved child restraint	–	✓*	o	✓*	✓*	✓	✓
Driver and passenger airbags	✓	✓	✓	✓	✓	✓	✓
Entry door grab handle & light	✓	✓	✓	✓	✓	✓	✓
ESP – Electronic stability program control	✓	✓	✓	✓	✓	✓	✓
Fire extinguisher/s	✓	✓	✓	✓	✓	✓	✓
High mounted rear brake light	✓	✓	✓	✓	✓	✓	✓
LP gas leak detector	✓	✓	✓	✓	✓	✓	✓
Reverse camera	o	o	o	o	✓	✓	✓
Safety cupboard door catches	✓	✓	✓	✓	✓	✓	✓
Smoke detector	✓	✓	✓	✓	✓	✓	✓

#### CHASSIS FEATURES

Air bag suspension – rear	–	–	–	–	–	–	–
Air bag helper springs – front	–	–	–	–	–	–	✓
Air conditioning	✓	✓	✓	✓	✓	✓	✓
Bucket seats – Colour co-ordinated	o	✓	o	✓	✓	✓	✓
Cabin entry side steps	✓	✓	✓	✓	✓	✓	✓
Cruise control	✓	✓	✓	✓	✓	✓	✓
Electric driver & passenger windows	✓	✓	✓	✓	✓	✓	✓
Electric mirrors with demist function	✓	✓	✓	✓	✓	✓	✓
GVM upgrade	–	–	o	–	o	–	–
Height & reach adjustable steering column	✓	✓	✓	✓	✓	✓	✓
Power steering	✓	✓	✓	✓	✓	✓	✓
Remote control central locking with engine immobiliser	✓	✓	✓	✓	✓	✓	✓
Swivel seat/s	✓	✓	✓	✓	✓	✓	–
Swive seat/s with arm rest/s	✓	✓	✓	✓	o	✓	✓
Wheel dress rims	✓	✓	o	✓	✓	✓	✓

o = Option   ✓ = Standard   – = Not available   \* = Select models   T = Tourer





# **AVIDA** RV HELP

## 24HR ROADSIDE ASSISTANCE

- Peace of mind
- Free for 2 years with new vehicle purchase
- 24 hours a day / 7 days a week / 365 days a year



## 3 YEARS WARRANTY

- 3 year warranty or 1 million km warranty
- 5 year structural guarantee
- Strong aftersales philosophy with fast spare parts turnaround

## EXTENSIVE SUPPORT

- 120+ accredited service and dealer locations Australia wide
- We have a factory trained and accredited Dealer network
- Web based service centre finder

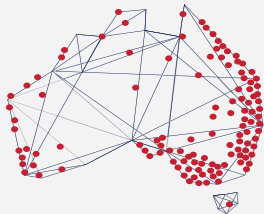

## INDUSTRY ACCREDITED

RVMAP, Australia's Caravan Industry accreditation program requires all RVs produced by members to comply fully with all safety regulations, including Australian Design Rules and Australian Standards. The RVMAP Australia Badge is the seal of approval that ensures Australian RV buyers can buy with confidence.



## AVIDA EXTRAS

### **AVIDA FINANCE**

Ask your dealer about the attractive and competitive Avida finance plans available.

### **AVIDA RV CLUB**

Enhance your RV lifestyle with the Avida RV Club. Save with our fantastic discounts and benefits for members, have fun on our safaris to interesting places, create lifelong friendships at our fantastic gatherings or listen and learn at our interesting and varied seminars.

Just call AUS 1800 CLUB RV (2582 78) or NZ 0800 CLUB RV (2582 78) to find out more about joining the club.

### **AVIDA FACTORY TOUR**

Why not visit our modern manufacturing facility at Emu Plains, west of Sydney where you can relax at our Visitors Centre and enjoy guided factory tours which are held on Fridays from 1:15pm by APPOINTMENT ONLY. Tour numbers are limited, so book a factory tour online today.

### RV Insurance supported by **AVIDA**

Our insurance policy has been specifically tailored to motorhomes and you, the people who drive them. Avida insurance offers, amongst other things, automatic \$10,000\* contents cover for your personal belongings in your motorhome, far more than any other motorhome insurance product. Jewellery items, certain sporting equipment and fishing equipment are included up to defined limits. And we haven't forgotten your pets. Ask for a full brochure.

\* Avida RV Club members only. Visit website for full T&C's

[www.avidarv.com.au](http://www.avidarv.com.au)

Your Local Avida RV Dealer is:



### AVIDA RECREATIONAL VEHICLES

For more information contact your nearest Dealer on (AUS) 1300 4 AVIDA (28432) or (NZ) 0800 946 643



For further information scan this code using a QR code reader on your smart phone.

Please read: Due to continuous improvement, specifications are subject to change without notice. For more detailed information please contact your nearest dealer.

