



**ZEBRA**



## ZEBRA

Our ZEBRA is a small lift mounted mistblower but packs a punch! Simple in design, strong structure and easy to use, make it popular with many vine growers.

### Major features include:

A 321/10 diaphragm pump capable of delivering a mighty 73 l/min at 25 bars pressure.

Manual operating units, M70/02 and SV/2 units with solenoid valves and a remote control box to fit in your tractor cab are all available to meet your needs. Choose from the range of famous HARDI tanks in sizes of 300, 400, 600 and 800 litres.



### SV/2 operating unit

Well proven, controls that are conveniently placed close to your driving position. This unit allows hand control of the pressure regulation and tank agitation.



### Solenoid valve control

Quick and easy adjustments of the on/off valve, made from the security and comfort of your tractor cab.





## ATLAS boom

### **Simple to adjust and operate but with low maintenance costs.**

Setting up the ATLAS boom and spraying spouts is very intuitive. No special tools nor long explanations are needed! Every operator soon makes the few adjustments needed to gain the air and spray mix required.

Most vine spraying tasks can be met. Early in the season when the vegetation is very open, sprays can be applied from just one side of the row. Adjusting each upper spout to spray both adjoining rows means four row spraying will be your normal practice.

Later in the season, your vine vegetation will have greatly increased so the upper spouts can then be adjusted to spray just the two adjoining rows. Spraying these rows from both sides ensures a complete and uniform spray cover despite a big increase in leaf and shoot coverage.

*ATLAS EXTEND booms have widths of 4.15 metres and height adjustments of 0.5 metres to meet most vine spraying needs.*



The ATLAS EXTEND boom is easily and quickly 'clicked' from its transport location into the open spraying position. This newly developed 'breakaway', although light to use, is designed to be sure that the booms will always firmly stay in their intended position.

## Blowers / Air kits

Designed by aerodynamic specialists, these air kits are the key to better air distribution, lower noise levels and less power consumption; all benefits that deliver enhanced spraying efficiency, greater savings on fuel costs and less environmental impact.

Blowers are adapted to your plantation and growing techniques.

HARDI's full range of air kits, fans and turbines are made from the finest steel and aluminium. Note carefully every major feature such as the patented centrifugal clutch that minimises wear to the sprayer and tractor as well as economising on fuel and enhancing your safety.



### L-540

10.000 m<sup>3</sup>/h. Suitable for treatments in vine and berry bushes. Belt driven. Disengagement. Centrifugal clutch. Air intake from the rear. Polyethylene fan housing. Power consumption: 10 kW

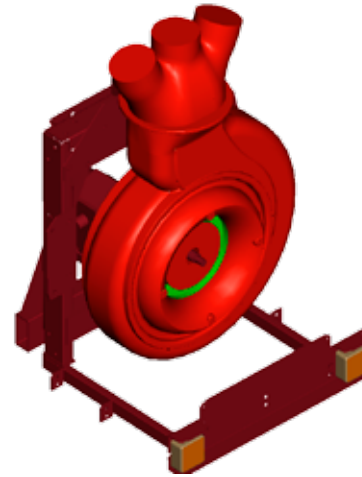

### HF-540

14.000 m<sup>3</sup>/h. Suitable for treatments in vine and berry bushes. Two speed gear box with neutral position. Centrifugal clutch. Air intake from the rear. Polyethylene fan housing. Transport lights (optional in ZENIT). Power consumption: 16 kW.

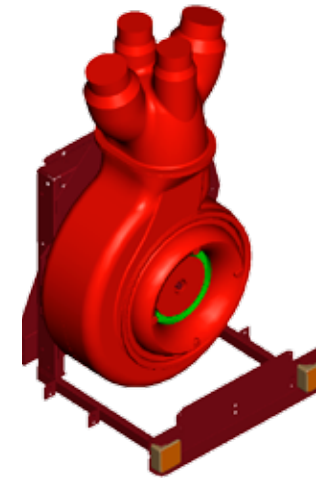

### HF-540D

18.000 m<sup>3</sup>/h. Suitable for treatments in vine and berry bushes. Two speed gear box with neutral position. Centrifugal clutch. Air intake from both rear and front. Polyethylene fan housing. Transport lights (optional in ZENIT). Power consumption: 22 kW.

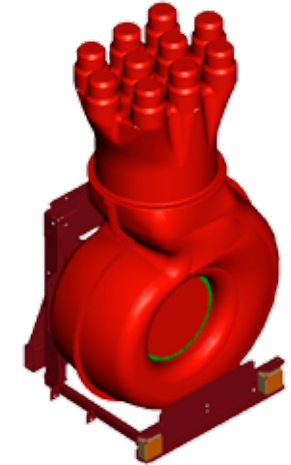

### HF-600D

27.000 m<sup>3</sup>/h. Suitable for vine in hedge row plantation. Two speed gear box with neutral position. Centrifugal clutch. Transport lights. Air intake from both rear and front. Polyester fan housing. Power consumption: 22 kW.

## Gear box and Pump



The HARDI heavy-duty gearbox stands up to the extreme conditions that orchard applications provoke, in very warm climate conditions as well as in severe terrain, where engine revolutions cannot maintain constant.

- Safety device to avoid unintended disengagement.
- Strong all-in-one body casing with simplified greasing needs.
- Easy access.

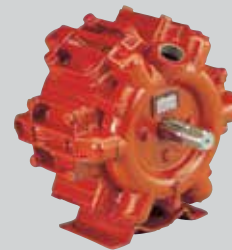

HARDI diaphragm pumps need no introduction! From the very beginning, these pumps were exclusively designed and made for agricultural and horticultural sprayers and, for decades, have continued to uphold their world leading position. Every need is met. Look, for example, at:

**Model 363** with 6 diaphragms that can deliver 140 to 195 l/min at pressures of up to 20 bars whilst the **Model 321** has 2 diaphragms and will deliver an output of 70 l/min at a pressure of 25 bars.

### Features

- Self priming
- Able to run dry without damage
- Grease lubricated crankcase
- Chemical resistant diaphragms and valves
- Can be used to rotate clockwise or anti-clockwise
- Easy to service without special tools.



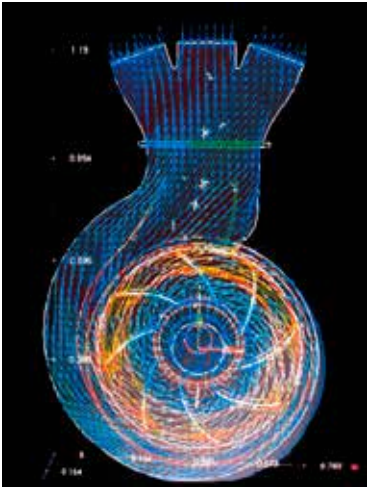

Designed by aerodynamic specialists, these air kits are the key to better air distribution, lower noise levels and less power consumption; all benefits that deliver enhanced spraying efficiency, greater savings on fuel costs and less environmental impact.

## Operating units CB/2 and CB/4

Precision spraying is dependent on these - the very best - valve controls and constant pressure systems. Spray computer use is aided with the addition of a sonic flow meter.

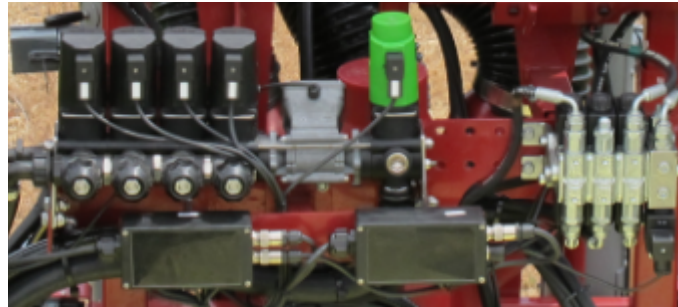

### M70

Easy to use and very effective manual regulation control systems.

The M70/2 control unit includes the main on/off valve, an easy to read pressure gauge and the distribution valves for 2 spray lines.

Note that spray guns can be usefully connected directly to the manifold.



### SV/2

Electrically operated Solenoid valves on the SV/2 control system allow the operator to control the main on/off valves and the two distribution valves from the safety and convenience of the cab.

Made of brass and fitted with a precision pressure gauge these units are of the highest standard. Pressure control is manually adjusted by the operator usually during calibration.



## Controls



Z hydraulic booms have the option to benefit from extra comforts of joystick controls. All your main boom movement and spraying controls conveniently to hand from the safety of your cab.



HC3100 electric control units easily fitted and used from the tractors switch panel.

Although the HC3200 control box is slightly larger, it neatly incorporates every sprayer function into one unit; a benefit that makes their use more than justifiable in today's often cluttered tractor cab. These units are standard with V and Z hydraulic functions.



## LB



Ideal for the smaller vineyard user and offering great safety in use on hilly terrains. These popular sprayers are available with or without the vine deflector that offer a very uniform air distribution.

## ZEBRA



There is no doubt that the ZEBRA can offer professional solutions to all the challenges of spraying vineyards with the most narrow of access between cropping rows. Choose your boom from the 3 ATLAS options to meet any need; very narrow access to 'over- the-row' spraying.

## ZENIT



Large vine plantations and contractors demand all the benefits of the ZENIT range. Tank sizes up to 1200 litres and the BOXER booms ensure these professionals can meet any vine spraying challenge. Easily adjusted booms are just one feature offered by this range to ease the rapid and safe adaptations from one spraying need to another.



## ZATURN



Narrow access rows of just 0.94 metres can be sprayed using the ZATURN COMPACT with tank sizes of 800 or 1000 litres.

Larger and slightly wider ZATURN 1000, 1500, 2000 and 3000 litre are ideal for the larger vineyards and soft fruit plantations. Choose your ZATURN to meet your needs from the JET, BOXER or CRONOS range.

## ZATURN



The ZATURN range has won the poll position in the world of vine spraying. Trend setting designs allow this sprayer to be available in versions to meet almost every need. Every detail is a winner. Look at the clean design and the outstanding weight balance; features demanded to meet every need.

Consider the benefits, for example, of the front mounted rinsing tank that are hidden in its detail; better sprayer cleaning = greater crop safety; better weight balance = greater hill stability, yet all integrated into the flowing ZATURN lines.

## MERCURY



No other vine sprayer has been sold for use in such numbers as the MERCURY. A success story owing much to its design, bullet-proof strength and a diversity that offers, for example, tank sizes up to a mighty 4000 litre capacity.



*Høje Taastrup,  
Denmark*



*Nørre Alslev,  
Denmark*



*Savigny,  
France*



*Beaurainville,  
France*



*Davenport,  
USA*



*Lleida,  
Spain*



*Adelaide,  
Australia*

## HARDI - The Sprayer

HARDI INTERNATIONAL A/S is an international group whose basic idea is to satisfy the user's requirements for quality products which ensure efficient, punctual and precise application of crop protection products. Our worldwide distribution and sales network comprise more than 100 countries where we are represented by importers, agents and sales subsidiaries. These are situated in Sweden, Norway, Denmark, the UK, France, Spain, North America, Germany and Australia.

Since 1957 HARDI has committed to the ever-increasing demands for efficient and precise plant protection. HARDI is the trendsetter within application of crop protection products. To achieve this position continued developments and innovation are essential. HARDI is committed to the long term future of plant protection.

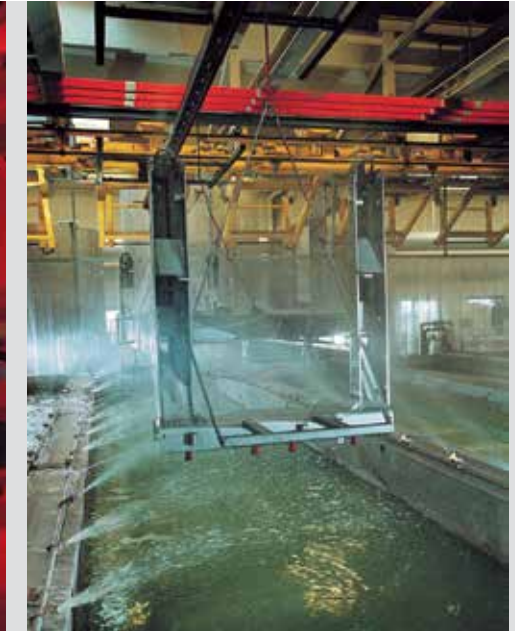

## Superb surface treatment

The high-technology surface treatment contains 13 treatments, including an Oxsilan pre-treatment and powder coat painting of all major components.

Together with the Delta/Magni treatment of nuts, bolts and other items, we supply high corrosion protection of our products. The chassis, the boom and all other steel parts have been pre-treated with Oxsilan followed by a high-quality coating of powder paint.

## Testing procedures

Sprayers leaving HARDI INTERNATIONAL A/S are tested according to the strictest quality standards.

The staff of the assembly line is accredited to match the demands from both NSTS (National Sprayer Testing Scheme), UK and JKI (Julius Kühn Institut), Germany. This ensures that the highest quality sprayers are delivered to farmers.



## HARDI Ltd.

Watling Suite (unit B)  
High Cross Business Park  
Coventry Road • Sharnford  
Leicestershire • LE10 3PG  
Phone: 01 455 22 22 30 • Fax: 01 455 22 22 40  
E-Mail: sales@hardi-uk.com • www.hardi-uk.com

## HARDI AUSTRALIA Pty. Ltd.

534-538 Cross Keys Road, Cavan • South Australia, 5094  
Phone: QLD(07)3375 3544, NSW(02)96274555,  
VIC(03)9310 2211, SA(08)8343 9933, WA(08)9353 2088  
Email: info@hardi-aus.com • www.hardi.com.au

## HARDI INTERNATIONAL A/S

Helgeshej Allé 38 • DK 2630 • Taastrup • Denmark  
E-Mail: hardi@hardi-international.com • www.hardi-international.com



**The Sprayer**

## ILEMO HARDI S.A.U.

Poligono Industrial "El Segre", parcela 712-713  
Apdo. de Correos 140 • 25080 Lleida • Spain  
Tel.: +34 973 20 81 47 • Fax: +34 973 18 42 47  
E-mail:ilemo@hardi-es.com • www.hardi.es

Read more at [www.hardi-international.com](http://www.hardi-international.com) and [www.hardi.es](http://www.hardi.es)

*HARDI reserves the right to change the specifications without notice.  
Illustrations shown may include optional extras and accessories.*